

ART. ZE-202-DP

Concealed combination with paper towel dispenser, soap dispenser and waste bin

Concealed combination with paper towel dispenser, soap dispenser and waste bin, black

Concealed combination with paper towel dispenser, soap dispenser and waste bin with 24 litre capacity. With internal lockable paper towel and soap dispenser box. Stainless steel, surface black powder-coated in RAL 9005 deep black matt with fine structure | Dark Passion. Concealed element with internal lockable paper towel and soap dispenser and waste bin with approx. 24 litres capacity. The dispenser box is locked in the upper position with a key. By means of extremely robust guide rails the dispenser box can be lowered into the refill position. Capacity approx. 400 paper towels and 0.9 litres soap or disinfection fluid. Fitting to the stud system is made using aluminium fitting rails attached to the concealed element. Fitting is made for conventional drywall with 100mm stud construction. Made out of 1.2mm thick stainless steel. Suitable for paper towels with a folded length of approx. 215-250mm and a folded width of approx. 80-95mm.

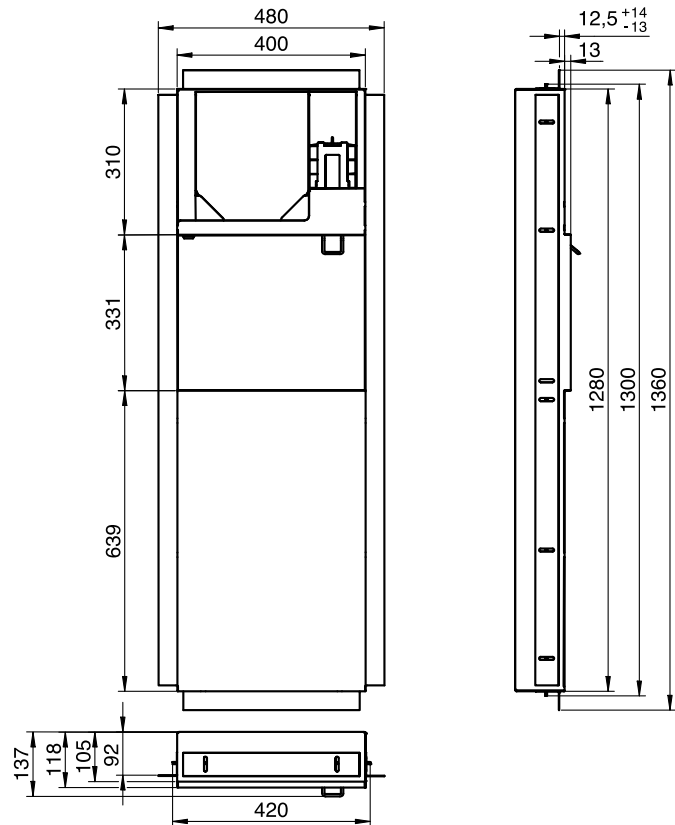

Mounting video

