

ART. ZE-140E-FO

Electr. behind-mirror soap dispenser for foam soap

Electr. behind-mirror soap dispenser for foam soap, with mounting plate, 0.8 l

Electr. behind-mirror soap dispenser for foam soap. With mounting plate. High quality pump. The capacity is 0.8 litres. 0.8 ml per stroke. The soap container can be removed for cleaning and refilling. Dispenser can be operated with battery (4x Alkaline 1,5V, Typ AA, C) or optional with direct power plug. The dispenser unit can be attached directly to the wall or to the lift modules.

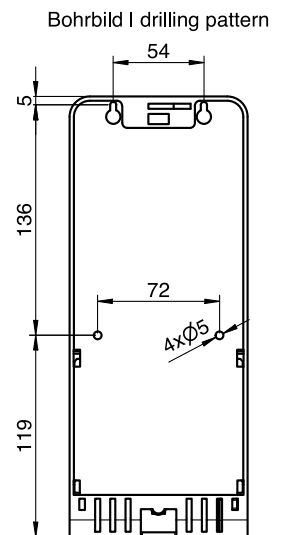
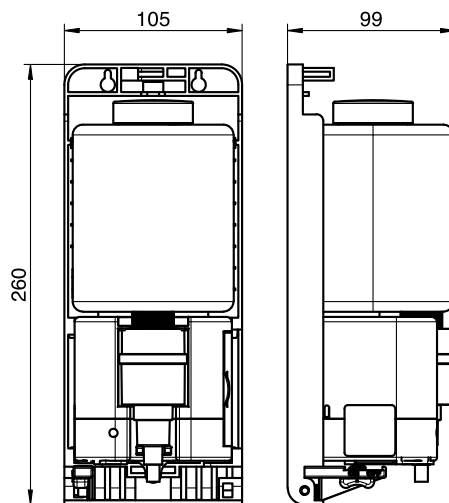

Batteriefach | Batterybox

