

ART. ZE-011

## Lift module D for behind-mirror fitting

**Lift module D for behind-mirror fitting for electr. hand dryers, hygiene glove dispensers or paper towel dispensers, stainless steel**

Lift module D for behind-mirror fitting for electr. hand dryers, hygiene glove dispensers or paper towel dispensers. Made of stainless steel. The element is made out of stainless steel and locked in closed dispenser position by using a key. For refilling purposes the lift module is lowered by means of a high-quality guide rail. A strong spiral spring supports the very smooth opening and closing of the lift module. Suitable for PU-010, ZE-111, ZE-112 and ZE-113.



geschlossen | closed

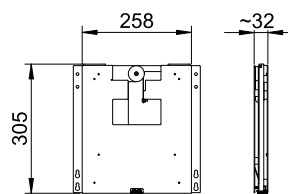

Bohrbild | drilling pattern

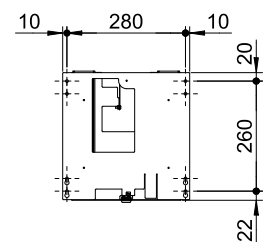

offen | open

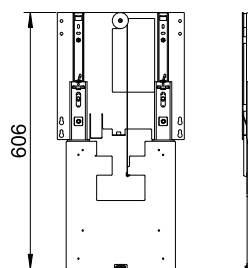

Mounting video

